

# Installation Instructions

## Honeycomb Shades

### Motorized Cordless



#### Getting Started

Remove shade from package. Save packaging until shade is installed and working to your satisfaction.

#### Tools:

- Level
- Measuring Tape
- Pencil
- Power drill (6mm hex driver and drill bit)
- Screwdriver



You will need to use the following fasteners for your particular mounting surface.

Surface	Fastener
Wood	Screws (Provide)
Drywall/Plaster	Wall Anchors, Expansion Bolts (Not Provide)
Metal	Sheet Metal Screws (Not Provide)

#### Check Component/Hardware:



(3/8"S, 1/2"D, 9/16"S, 3/4"S)

Installation Bracket

(1 1/4"S, 3/4"D)

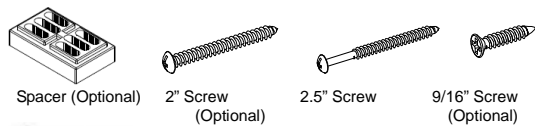

Spacer (Optional)

2" Screw (Optional)

2.5" Screw

9/16" Screw (Optional)

1 1/4" Installation Screw

#### Hardware Standard Quantity

Order Width (X)	X ≤ 56"	56" < X ≤ 105"	X > 105"
Installation Bracket	2	3	4
1 1/4" Screw (for Installation Bracket)	4	6	8
Spacer Block (Optional)	2	3	4
2" Screw (for Installation Bracket with 1~2pcs spacer block)	4	6	8
2.5" screw (for Installation Bracket with 4pcs spacer block)	4	6	8

**Note: Optional flat head screws included. Use as needed.**

#### Step 1: Bracket Installation

- Measure 1 9/16" (40mm) from both ends of the head rail. Mark the bracket location on the mounting surface. Proper alignment of brackets will make installation easier.
- When shade width is less than 24", the distance from both ends of the headrail is 1 3/16" (30mm).

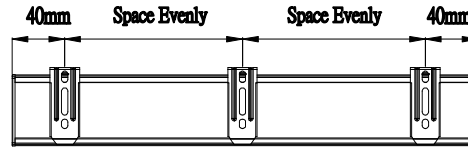

#### Inside Mount

• For 3/8"S, 1/2"D, 9/16"S, 3/4"S, align the front of brackets 1/16" to the edge of window opening as right drawing.

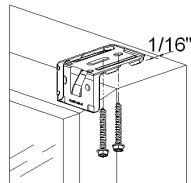

• For 1 1/4"S, 3/4"D, align the front of brackets to the edge of window opening as right drawing.

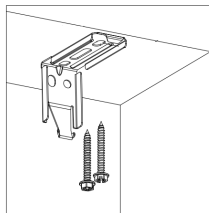

Use two 1 1/4" installation screws to secure brackets. Use wall anchors for drywall or plaster wall.

#### Outside Mount

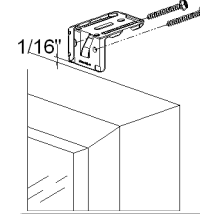

• For 3/8"S, 1/2"D, 9/16"S, 3/4"S, allocate a min. distance of 1/16" from wall to the bottom of brackets as left drawing.

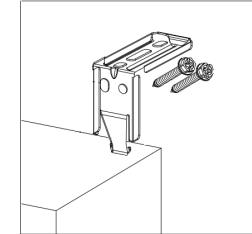

• For 1 1/4"S, 3/4"D, align the end of brackets with the top window frame as left drawing.

• Use two 1 1/4" installation screws to secure brackets. Use wall anchors for drywall or plaster wall.

Note: If spacer block is required, please follow the following guide:

Please always make sure the raised side of the spacer block is against the bracket. Use 2" screws for one or two pcs of spacers, and 2.5" screws for 4 pcs of spacers. See picture below:

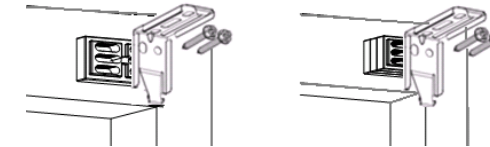

For shallow mounting, using 2pcs of flat head screw to secure the bracket as below

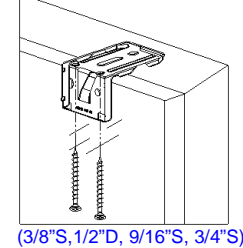

#### 2: Install the Shade

- Position head rail at an angle so that it is hooked to the front of the bracket. Then push it upward at the back to snap into the bracket.

**⚠ For proper installation, start with attaching the front of the headrail to the bracket.**

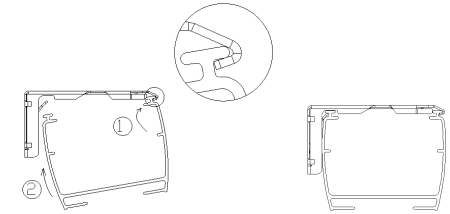

(3/8"S, 1/2"D, 9/16"S, 3/4"S)

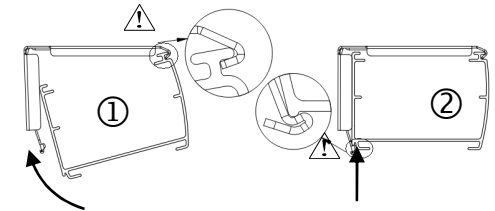

(1 1/4"S, 3/4"D)

#### Step 4: Install Remote Control Holder (Optional)

Position the remote control holder with two 9/16" screws and the distance between screws is 3 1/4" and screws protrude 1/8".

Attach the remote control holder to the screw.

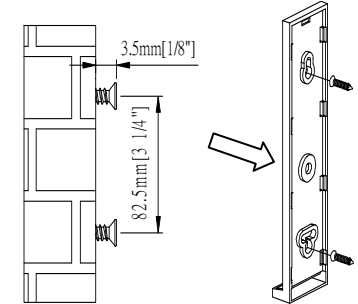

★ Congratulations! You have finished installing the blind.

## How to Install Hold Down Brackets (optional)

### A. For Hold Down Bracket.

Use #6 3/4" screw to secure each bracket.

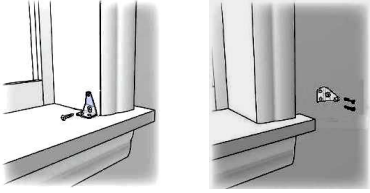

### B. For Magnetic Hold Down

Use M3x15mm screw to secure the magnet catch at the below location. Make sure the magnet catch align with the pre-installed magnet on shade bottom rail.

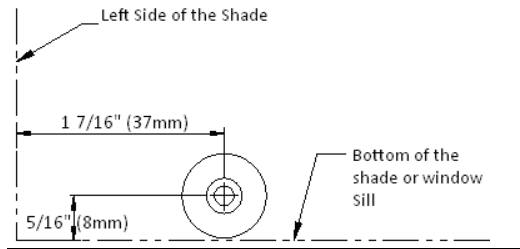

## ★ Shade Operation

Connect the battery wand or AC/DC adapter to the motor.

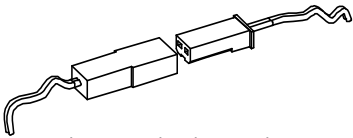

Install remote battery and make sure the screen shows the right channel for the shade, and then the shade can be operable. Please refer to the remote instructions for adjustment.

Note: Channel 1 is the default shown on the remote screen and channel 0 controls all shades programmed in one remote.

## ★ Remove the Shade

Fully raise the shade, and then gently pry the bracket off the head rail with a flat screwdriver. Remove the shade.

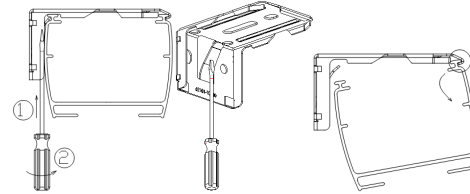

(3/8" S, 3/8" D, 9/16" S, 3/4" S)

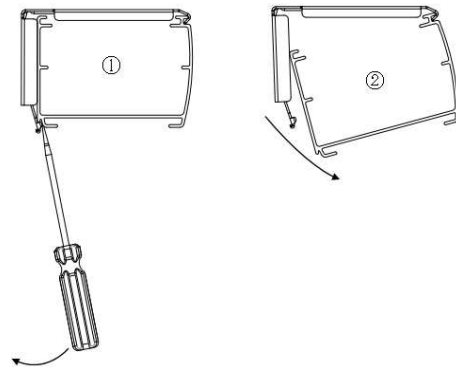

(1 1/4" S, 3/4" D)

## ★ Manual Control Button

When remote is not available, the shade can be operated by the manual control button.

⚠ Do not press the manual control button over 4secs.

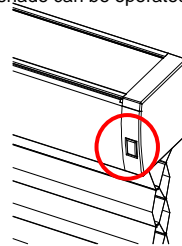

## ★ Note

Our remotes are pre-programmed and ready to use.

## ★ Cleaning the Shade

Routine cleaning will help maintain the beauty of your shade. The shade can be cleaned by using a soft brush, vacuumed with a low suction hand-held vacuum, cleaned ultrasonically (specify that a mild solution must be used and that the head rail should never be immersed in liquid), or dampen a clean cloth with a warm water and mild detergent solution to dab the spot until it's gone (do not rub!).

⚠ Do not spray the liquid to the electric parts of the motorized shade.